



KU AMBIANCE

presented by
Steven Hoel
Walt Morton
Margaret Keasberry
Tatsu Ishihara

hotei13@gmail.com

Ku Ambiance
15720 La Salle Ave.
Gardena, CA 90247
213-915-8872



KU AMBIANCE

Ku Ambiance showcases a unique design-fusion style aimed at the fine-art / luxury goods market. Our intent is to present modern interpretations of classic, thousand-year-old traditions in Japanese design. Our goal is to offer these new extraordinary art objects for sophisticated customers who want the ultimate in high-culture décor, fashion, art, and design.

The following pages contain product samples from a larger array of Ku Ambiance items including: Arita porcelain, traditional kakemono and other types of wall hangings, Japanese room screens, textile products, fine incense, silver jewelry, furniture, lamps, art objects, tile, Japanese fans, denim products, handbags, and more, all designed with unique Ku qualities to reflect the traditions of Japanese culture & craftsmanship.





Contemporary Japanese Home.

Ku Ambiance in partnership with the finest traditional Japanese manufacturers has created unique, Japanese-inspired luxury furnishings.





The Finest Materials & Manufacture.

Premium hardwoods and hand finishes are standard. Customized to order.





Ku Ambiance furniture designs are a modern interpretation of the spirit of residential architecture called sukiya-zukuri. The sukiya style came from the tea ceremony, in fact the word sukiya refers to the building in which the tea ceremony is performed. The sukiya style which evolved from the Azuchi-Momoyama period and shoin style, was in direct contrast to the grand and magnificent settings of the shoin-zukuri. In the sukiya, the smaller and simpler is considered the best design. Some tea huts went from six tatami down to 1 3/4 tatami in size. Sukiya style combined a smaller, simpler setting with the features of a more delicate, natural and unornamented style. The incorporation of the sukiya with the shoin developed into the sukiya-zukuri. This style became the popular style for townspeople's residences in the mid to late Edo period (1750 -1867). It is this style that most represents the traditional Japanese interior. It is also this style that has contributed to the compressed living space of Japanese life. Recently, it has been seen to also reflect elements of Bauhaus, Der Stijl, and Craftsman architectural elements.



From the beginning of the 17th century, **Arita porcelain** was valued above gold and silver by members of the Hapsburg family, the Bourbon family, the Hanover family and other famous families who were fascinated by this beautiful porcelain. August the First, the king of Saxony in Germany, was a fanatical collector. In Arita's porcelain, therefore, we find various nuances of the culture and tradition of both Asia and Europe. Inspired to explore this historic East-West artistic interface in Arita porcelain, American contemporary artist and tattoo legend **Don Ed Hardy** traveled to Arita to work with the traditional ceramics craftsmen in a unique collaboration. The result is a collection of porcelain that vaults the historical forms of the Arita craftsmen into the 21st century, with post-modern interpretations and inversions of century-old forms that have been re-invigorated via Hardy's neo-Californian sensibility and signature personal style.



Takashi Yokoyama makes **Ku Ambiance jewelry** by the process of lost-wax casting, sometimes called by the French name of *cire perdue*. In this process silver and gold jewelry is cast from the artist's original tiny sculptures. There are many complicated steps in making jewelry this way, each requiring the ultimate in detail-work at a near-microscopic level.

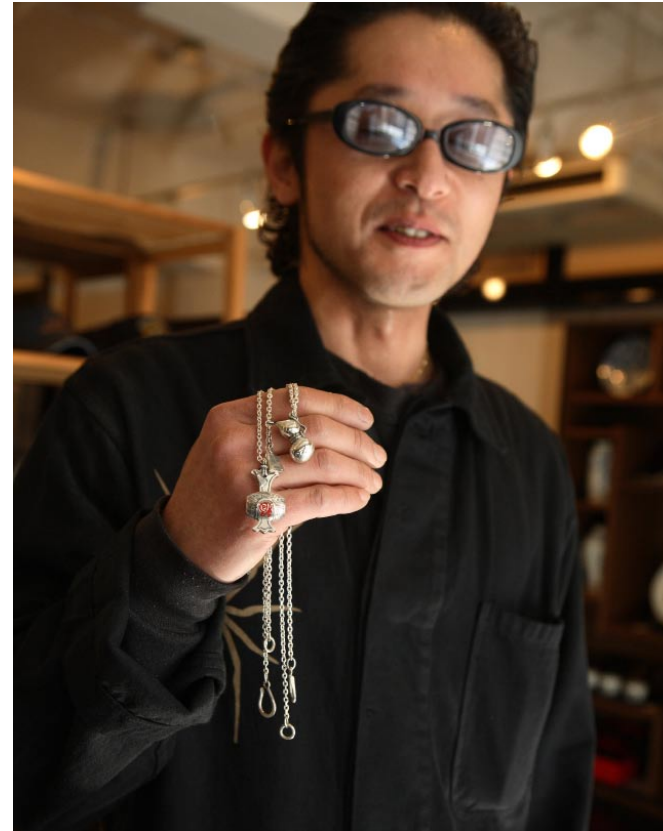

Ed Hardy Kakemono

A kakemono is intended to be displayed vertically as part of the interior decoration of a room. It is traditionally displayed in the tokonoma alcove of a room especially designed for the display of prized objects. When displayed in a chashitsu, or teahouse for the traditional tea ceremony, the choice of the kakemono and its complementary flower arrangement help set the spiritual mood of the ceremony. Kakemono can be easily and quickly changed to match the season or occasion.

The kakemono was introduced to Japan during the Heian period, primarily in the form of Buddhist images for religious veneration, or as a vehicle to display calligraphy or poetry. From the Muromachi period, landscapes, flower and bird paintings, portraiture, and poetry became the favorite themes.

Ku Ambiance kakemono are contemporary manufacture designs by Don Ed Hardy, internationally famed artist, designer and tattoo artist.



Contemporary Japanese Materials.

Ku Ambiance is the exclusive importer of a variety of unique natural materials including bamboo and other natural Japanese fiber materials, indigo dyed fabrics, denims, and woven materials. Though these are all extremely traditional materials in Japan, they are as “green” as the very latest developments in sustainable technology.

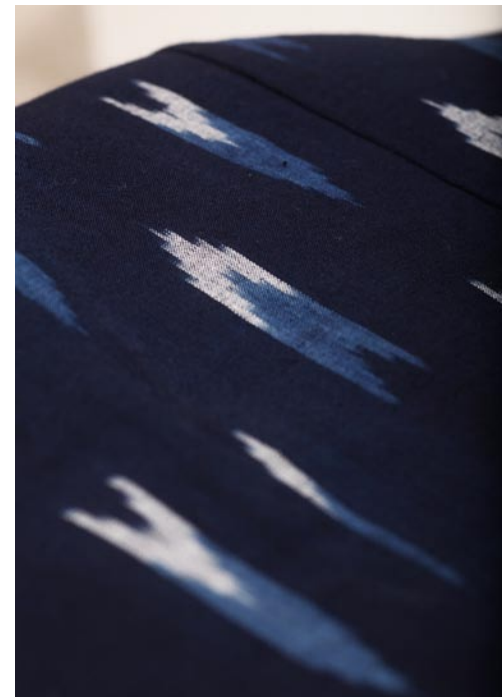



Bizen pottery, along with the pottery of the Seto, Tokoname, Tanba, Echizen and Shigaraki regions is one of the six potteries of the Middle Ages. It is one of the oldest schools of pottery in Japan, tracing its roots back to the “Sueki” found in ancient burial mounds. It underwent numerous modifications from the Heian era up to the beginning of the Kamakura era to make it more durable. This led to the creation of a superior pottery for daily use and resulted ultimately in today’s Bizen pottery, with its unglazed, natural beauty. For more than one thousand years, the tradition of Bizen pottery has continued uninterrupted.



The Bizen potter **Shibaoka** creates amazingly imaginative forms inspired by raw nature and monstrous forms of the imagination.





Kasuri Hand-loomed fabrics and fashions:

As part of a 300-year old tradition, we offer hand-loomed fabrics suitable for clothing, linens, or furnishings. A variety of colors including natural indigo-dye patterns both historic and new.





Kasuri fashions:

Both premium casual and couture, our clothing is personal, modern, but with the best of Japanese tradition and detailing.



Ku Ambiance Art Ceramics: all are selected from currently working master potters and ceramics artists using a variety of techniques, glazes, and shapes both traditional and new to Japan.



Functional Home Ceramics, all are selected from hand-crafted small factories with techniques, glazes, and shapes both traditional and very modern and “New Japan.”



Zanshin Home Elements: lighting and screening solutions that borrow from the traditional shapes of Japan but realized in new finishes, highly functional, very modern and “New Japan.”

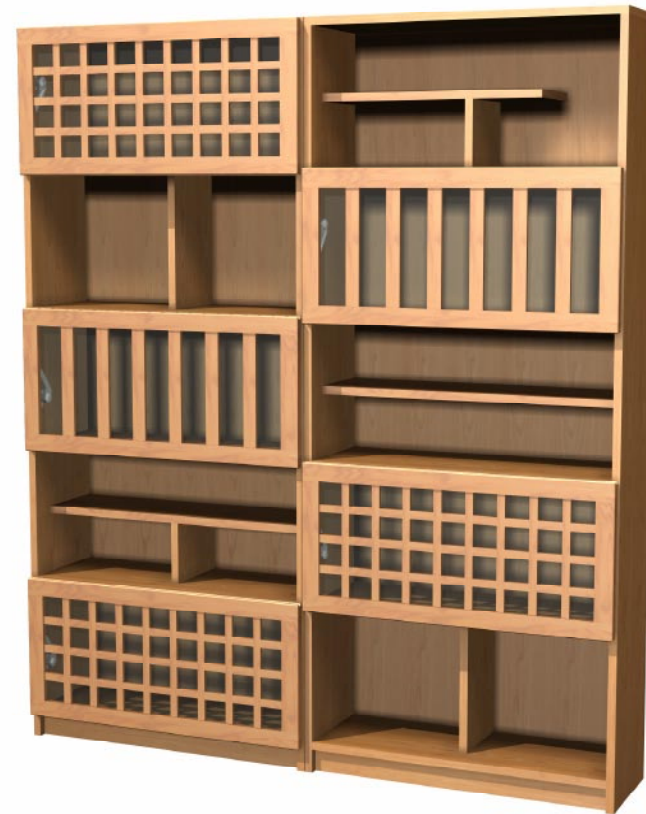

Zanshin 3 : highly modular storage rack evokes traditional shapes of Japan but is functional, very modern and in the style of “New Japan.”